

MCW5000-PX™ (REV.2) WATER-BLOCK

INSTALLATION GUIDE FOR XEON™ PROCESSORS

Parts list

Parts	QTY	PARTS	QTY
MCW5000-PX™ assembly	1	Arctic Alumina Thermal compound	1
Tube inserts	4		
Tube removal tool	1		

This product is intended for expert users. Please consult with a qualified technician for installation. Improper installation may result in damage to your components. Swiftech assumes no liability whatsoever, expressed or implied, for the use of these products, nor their installation. The following instructions are subject to change without notice. Please visit our web site at www.swiftnets.com for updates

1. Before you install the MCW5000-PX™ water-block:

a. **Prepare two pieces of tubing** of sufficient length to connect to the rest of your circuit. The cuts must be square as shown in figure 1 or leaks may occur:

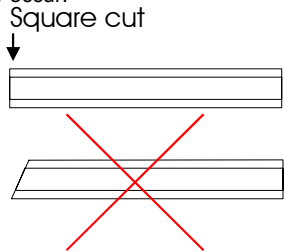

Figure 1

b. **Install the provided plastic tube inserts** at each end of the tubes, as shown in figure 2: these inserts are absolutely **imperative** when using any kind of **soft** tubing, such as vynil, ClearFlex, Taigon, etc...



Figure 2



Figure 3

c. **Spread a little bit of grease or soap** (Vaseline, dishwashing liquid, etc..) around the tubing. It helps pushing the tubes in, particularly with Clearflex™ tubing, which features a very "sticky" surface.



Figure 4



Figure 5

d. **Fully insert both tubes into the fittings.** The tip of the plastic tube inserts should be flush with the inlet and outlet openings, as shown in figure 4 above. Inserting the tubes requires a firm push, accompanied by a twisting motion.

2. Preparing your Motherboard

- Remove the existing heat sink
- Carefully clean the CPU.
- Lightly coat the CPU with the provided thermal compound. **Only a paper-thin coat is necessary.** It should be applied using preferably a razor blade, or a credit card, held between thumb and index at a 45-degree angle.

3. MCW5000-PX™ water-block installation diagram

The MCW5000-PX water-block installs using Intel's validated retention clips. Please use the retention clips, and installation guide provided with your motherboard for installation of the water-block onto the CPU.

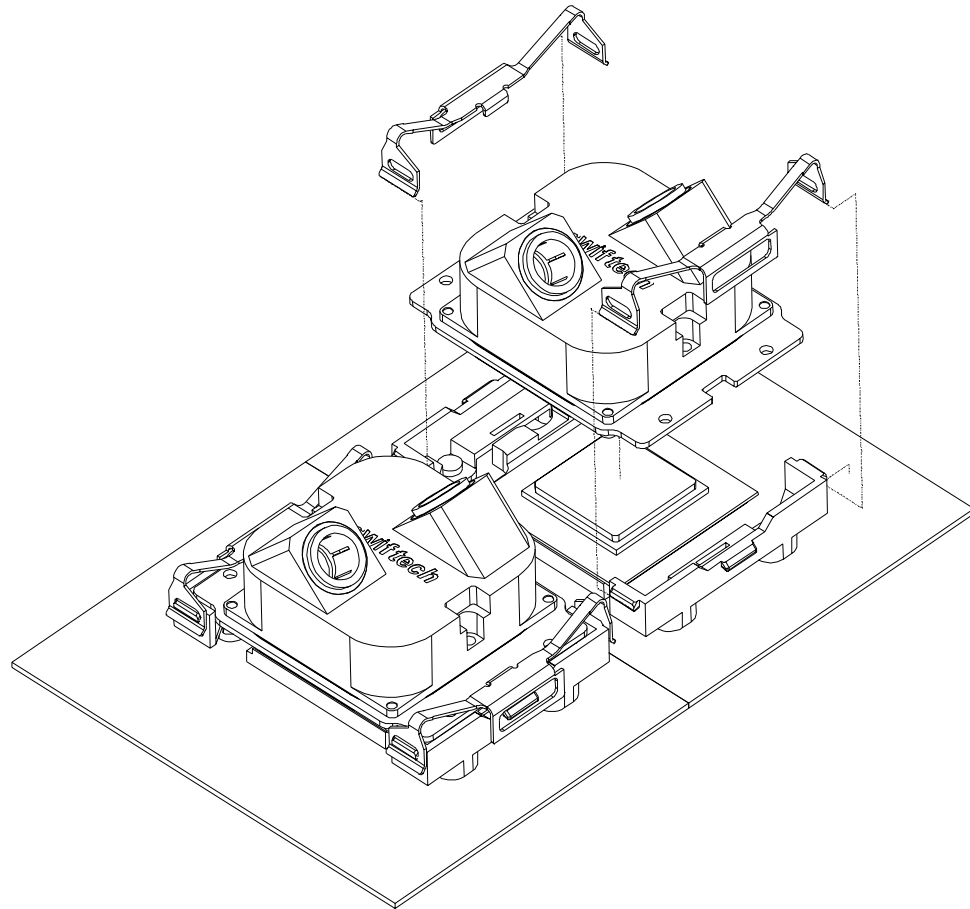

4. **Connecting the water-block(s) to the cooling circuit.**

FAQS:

- Inlet and outlet are interchangeable.
- In Multi-Processor environments, optimal water-block performance will be achieved by connecting them in series (outlet of one connected to the inlet of the other).
- Recommended coolant: distilled water+ algacides & corrosion inhibitors are mandatory (automotive antifreeze).

5. **Final inspection**

Once the installation is completed, **it is always a good idea to test the circuit for leaks, prior to powering up the computer.** Troubleshooting help is available on our web site at www.swiftnets.com, or by calling customer support at 562-595-8009.

Note concerning removal of the tubing: Push in collet squarely against face of fitting. A tube removal tool is provided with the MCW5000 block. With the collet firmly held against the face of the fitting, the tube can be safely pulled out. Do not attempt to pull the tube out without pushing squarely against the collet. This may result in damaging the fitting. Further details for using quick-connect fittings are also available here: http://www.johnquest.com/install_6.shtm#disconnect:

